

T-11-N R-11-E
SHEET-10

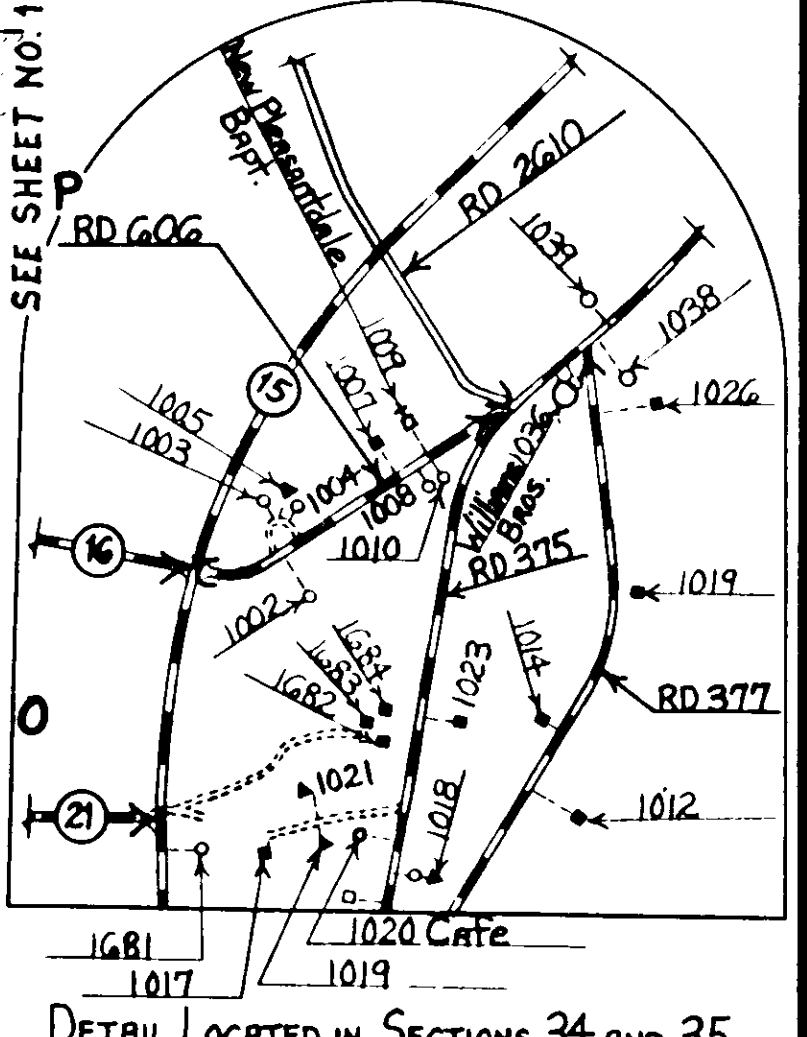
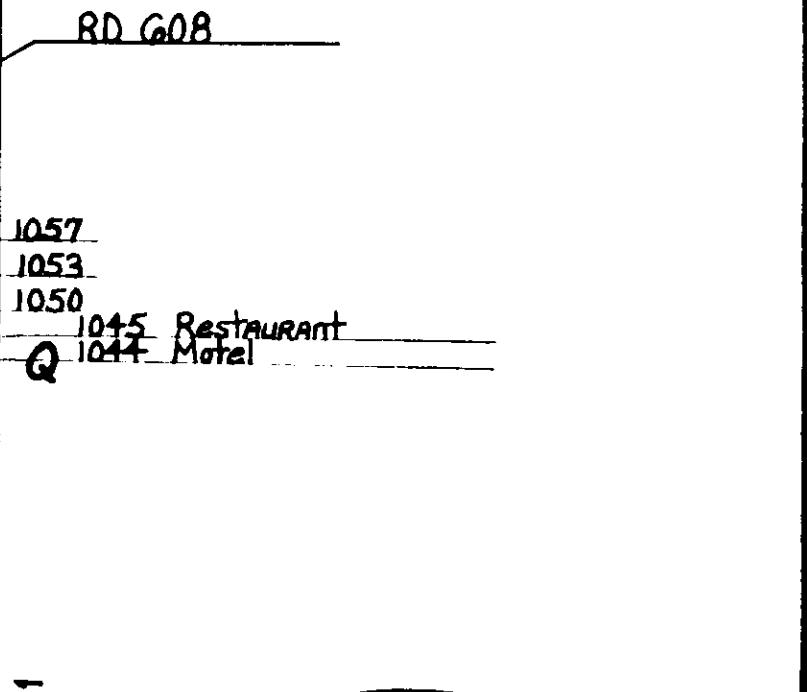
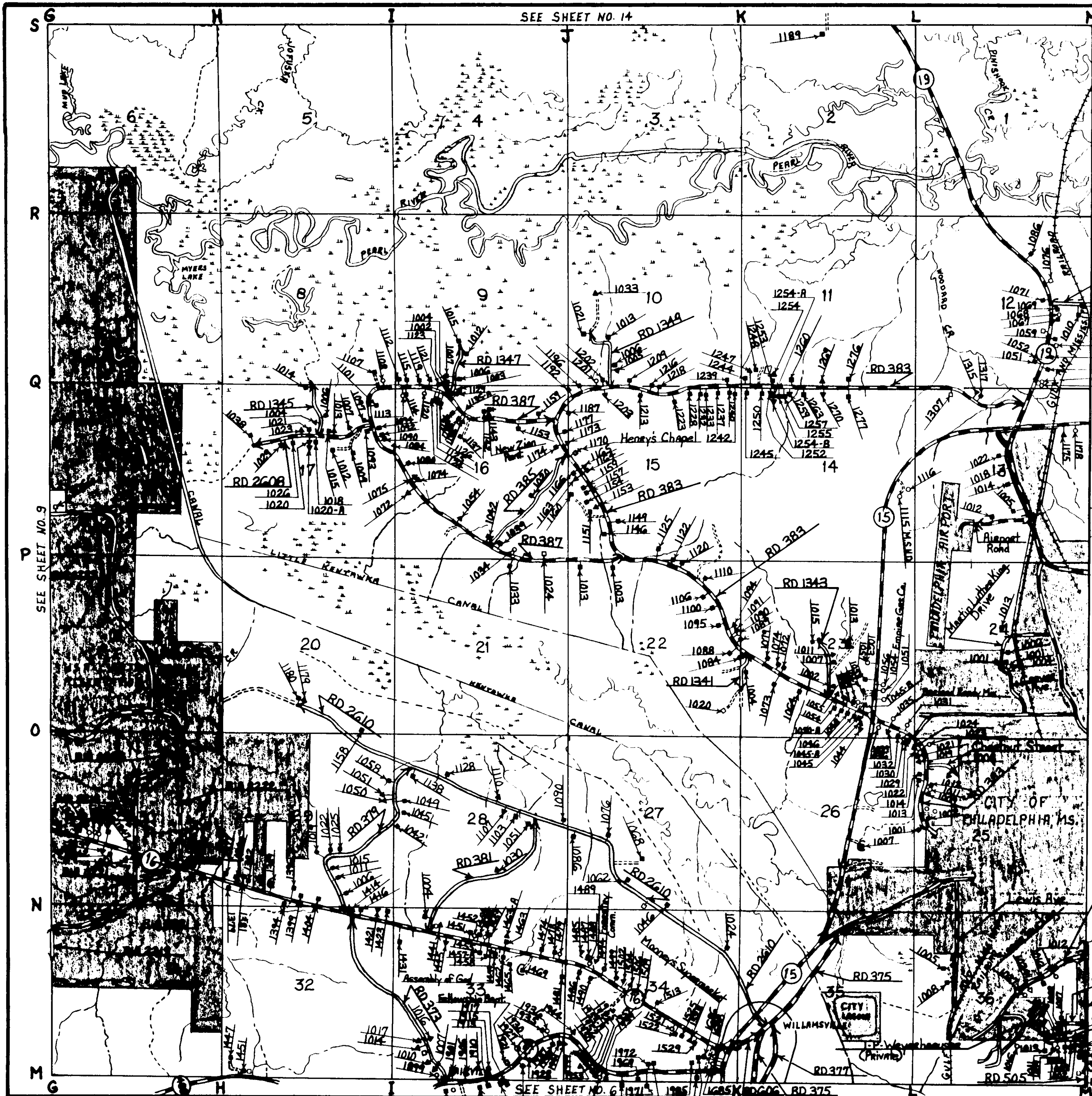

DETAIL LOCATED IN SECTIONS 34 AND 35

Weyerhaeuser Street

1701 Pandleton Square Apartments
Office w/ B Apartment Bldgs. Complex

<p>NESHOBA COUNTY ROAD AND HOUSE NUMBERING SYSTEM FOR THE NESHOBA COUNTY BOARD OF SUPERVISORS</p>		
<p>COX ENGINEERING Tom W. Cox P.O. Box 683 Philadelphia, MS. 39350</p>	<p>TELEPHONE: — OFFICE — GO1-656-3711 — HOME — GO1-656-1204</p>	<p>SHEET NO. 10 OF 16</p>

SEE SHEET NO. 14

SEE SHEET NO. 9

SEE SHEET NO. 11

SEE SHEET NO. 6

1900 1911 1916 1924 1958 1964 1974 1986 1988